

6

5

4

3

2

1

APPROVED: _____

DATE: _____ TITLE: _____

Rev	AWO #	Description	Date	Appr
-		RELEASED	12/6/05	

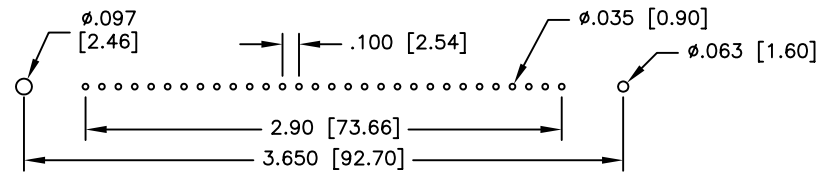
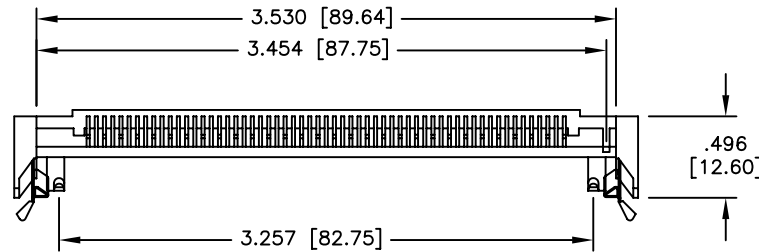
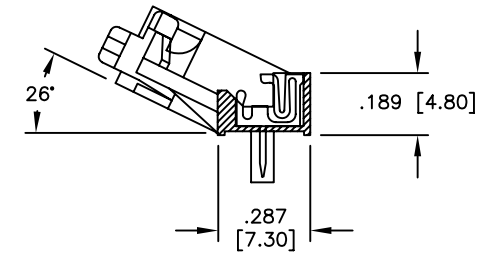
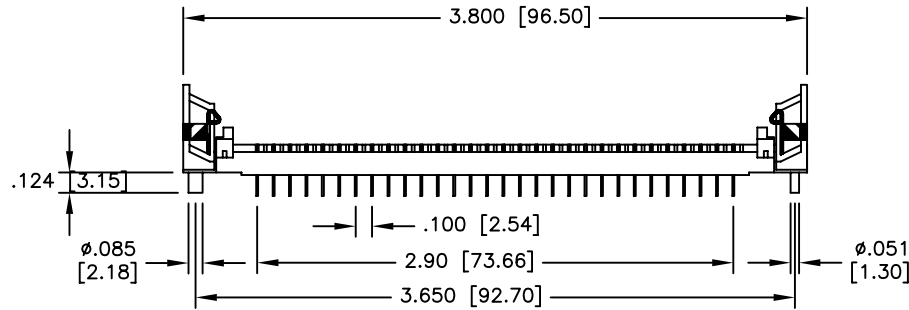

RECOMENDED PCB LAYOUT

SPECIFICATIONS:

Material:
Insulator: LCP, rated UL 94V-0
Insulator color: Black

Contacts: Phosphor Bronze
Plating:

Tin over Nickel underplate overall

Electrical:
Operating voltage: 30 VAC max.
Current rating: 1 Amp max.
Contact resistance: 30 mohms max.
Insulation resistance: 1,000 Mohms min.

Dielectric withstanding voltage: 1000 VAC for 1 minute

Temperature Rating:
Operating temperature: -40°C to +100°C

Environmental:
Lead free, RoHS compliant.

Recommended soldering temp: 235 for 5 sec.



UNLESS OTHERWISE SPECIFIED ALL DIMENSIONS ARE INCHES [MM] TOLERANCES: EXCEPT AS NOTED		ADAM TECH 909 Rahway Avenue, Union, NJ 07083 Phone: 908-687-5000 Fax: 908-687-5710	
INCHES HOLES			
.X ± .10	ØX ± .10	TITLE SIMM SOCKET, 130 POSITION, LOW PROFILE, SINGLE PCB	
.XX ± .020	ØXX ± .015		
.XXX ± .015	ØXXX ± .010	SIZE X	
APPROVALS		PART NO. SIMM-130-LTL	
DRAWN SS	DATE 12/6/05	REV. -	
CHECKED		REF:	
APPROVED		SCALE: NTS	
		SHEET 1 OF 1	

6

5

4

3

2

1