

## Important information on the X41 Tablet Digitizer Pen

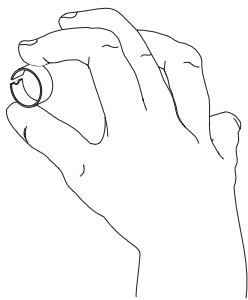

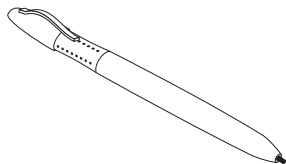
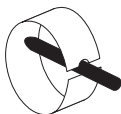
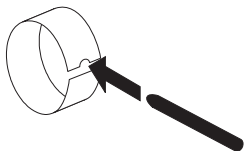
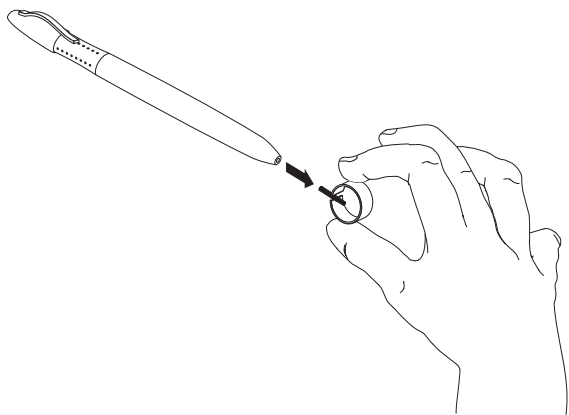

---

## Appendix A. Service and Support

The following information describes the technical support that is available for your product, during the warranty period or throughout the life of the product. Refer to your Lenovo Statement of Limited Warranty for a full explanation of Lenovo warranty terms.

---

### Online technical support

Online technical support is available during the life of your product through the Personal Computing Support Web site at <http://www.lenovo.com/think/support>.

During the warranty period, assistance for replacement or exchange of defective components is available. In addition, if your option is installed in a ThinkPad or ThinkCentre computer, you might be entitled to service at your location. Your technical support representative can help you determine the best alternative.

---

### Telephone technical support

Installation and configuration support through the Customer Support Center will be withdrawn or made available for a fee, at Lenovo's discretion, 90 days after the option has been withdrawn from marketing. Additional support offerings, including step-by-step installation assistance, are available for a nominal fee.

To assist the technical support representative, have available as much of the following information as possible:

- Option name
- Option number
- Proof of purchase
- Computer manufacturer, model, serial number, and manual

- Exact wording of the error message (if any)
- Description of the problem
- Hardware and software configuration information for your system

If possible, be at your computer. Your technical support representative might want to walk you through the problem during the call.

For a list of Service and Support phone numbers, see “Worldwide telephone list” on page B-22. Phone numbers are subject to change without notice. For the most current phone numbers, go to <http://www.lenovo.com/think/support> and click **Support phone list**. If the number for your country or region is not listed, contact your reseller or Lenovo marketing representative.

---

## Registering your option

Thank you for purchasing this Lenovo™ product. Please take a few moments to register your product and provide us with information that will help Lenovo to better serve you in the future. Your feedback is valuable to us in developing products and services that are important to you, as well as in developing better ways to communicate with you. Register your option on the following Web site:

<http://www.lenovo.com/register>

Lenovo will send you information and updates on your registered product unless you indicate on the Web site questionnaire that you do not want to receive further information.

---

## Appendix B. Warranty information

### Warranty Information

The complete Statement of Limited Warranty is available in 29 languages and may be viewed online at <http://www.lenovo.com/think/warranty> or can be obtained by calling the phone number for your country in the telephone list below.

Warranty Information applicable to your Machine:

1. Warranty Period: 1 year
2. Type of Warranty Service: Customer Replaceable Unit ("CRU") and Customer Carry-In or Mail-In Service
3. Statement of Limited Warranty Version: LSOLW-00 05/2005

For warranty service consult the telephone list below. For service in countries not yet listed, visit [www.lenovo.com/think/support](http://www.lenovo.com/think/support) and click Support Phone List for a current telephone listing. Phone numbers are subject to change without notice.

### Garantie

La Déclaration de Garantie complète, disponible dans 29 langues, figure sur le CD du produit ou est accessible en ligne, à l'adresse <http://www.lenovo.com/think/warranty>.

Garantie applicable à votre Machine :

1. Période de garantie : 1 an
2. Type de service de garantie : Unité remplaçable par l'utilisateur et service après-vente en magasin ou par courrier
3. Version de la Déclaration de Garantie : LSOLW-00 05/2005

Pour connaître les services de garantie, consultez la liste de numéros de téléphone ci-après. Pour les services de garantie dans les pays ne

figurant pas dans cette liste, reportez-vous au site <http://www.lenovo.com/think/support/> et cliquez sur Support Phone List pour obtenir une liste de numéros de téléphone en cours. Les numéros de téléphone font l'objet de modification sans préavis.

## Información de garantía

El documento completo Declaración de garantía limitada está disponible en 29 idiomas y se puede consultar en el CD del producto o en línea desde la dirección <http://www.lenovo.com/think/warranty> .

Información de garantía aplicable a su máquina:

1. Período de garantía: 1 año
2. Tipo de servicio de garantía: Unidad reemplazable por el cliente ("CRU") y servicio de transporte por parte del usuario o correo
3. Versión de la declaración de garantía limitada: LSOLW-00 05/2005.

Si desea información sobre el servicio de garantía, consulte la lista de teléfonos siguiente. Para obtener servicio en los países que no figuran listados, visite [www.lenovo.com/think/support](http://www.lenovo.com/think/support) y pulse Support Phone List para conseguir un listado telefónico actualizado. Los números de teléfono están sujetos a cambio sin previo aviso.

## Gewährleistungsinformationen

Die vollständige Erklärung über begrenzte Gewährleistung steht in 29 Sprachen zur Verfügung und kann über die Produkt-CD oder online unter <http://www.lenovo.com/think/warranty> angezeigt werden.

Für Ihre Maschine gelten folgende Gewährleistungsinformationen:

1. Gewährleistungszeitraum: 1 Jahr
2. Art des Gewährleistungsservice: "CRU"-Service (Customer Replaceable Unit, durch den Kunden austauschbare Funktionseinheit) und Anlieferung durch den Kunden oder per Versand

### 3. Version der Erklärung über begrenzte Gewährleistung: LSOLW-00 05/2005

Um Gewährleistungsservice in Anspruch zu nehmen, rufen Sie die entsprechende Telefonnummer aus der folgenden Liste an. Um Service in noch nicht aufgelisteten Ländern anzufordern, rufen Sie die Website unter [www.lenovo.com/think/support](http://www.lenovo.com/think/support) auf, und klicken Sie auf "Support Phone List". Daraufhin wird eine aktuelle Liste mit Telefonnummern angezeigt. Telefonnummern können jederzeit ohne Vorankündigung geändert werden.

#### Informazioni sulla garanzia

Le informazioni complete sulle istruzioni di garanzia limitata sono disponibili in 29 lingue può essere visualizzato dal CD del prodotto oppure online nel sito <http://www.lenovo.com/think/warranty>

Informazioni di garanzia applicabili alla propria macchina:

1. Periodo di garanzia 1 anno
2. Tipo del servizio di garanzia Customer Replaceable Unit ("CRU") e Customer Carry-In o Mail-In Service
3. Dichiarazioni della versione del limite di garanzia: LSOLW-00  
05/2005

Per il servizio di garanzia consultare l'elenco telefonico riportato di seguito. Per il servizio nei paesi non in elenco, visitare il sito [www.lenovo.com/think/support](http://www.lenovo.com/think/support) e fare clic su supporto Elenco telefonico per un elenco telefonico corrente. I numeri telefonici sono soggetti a modifiche senza previa notifica.

#### Informações de Garantia

A Declaração de Garantia Limitada completa está disponível em 29 idiomas e pode ser exibida utilizando-se o CD do produto ou on-line no endereço <http://www.lenovo.com/think/warranty>

Informações de garantia aplicáveis ao seu computador:

1. Período de Garantia: 1 ano
2. Tipo de Serviço de Garantia: CRU (Customer Replaceable Unit) e Serviço de Atendimento ou Mala Direta ao Cliente
3. Versão da Declaração de Garantia Limitada: LSOLW-00 05/2005

Para obter o serviço de garantia, consulte a lista telefônica abaixo. Para serviços em países que ainda não estão listados, visite o endereço [www.lenovo.com/think/support](http://www.lenovo.com/think/support) e clique em Support Phone List para obter uma lista atual de telefones. Os números de telefone estão sujeitos a alteração sem aviso prévio.



## Πληροφορίες σχετικά με την Εγγύηση

Το πλήρες κείμενο της Δήλωσης Περιορισμένης Εγγύησης είναι διαθέσιμο σε 29 γλώσσες και μπορεί να εξεταστεί από το CD του προϊόντος ή από την ιστοσελίδα:  
<http://www.lenovo.com/think/warranty>

Πληροφορίες σχετικά με την Εγγύηση που ισχύει για τη Μηχανή σας:

1. Περίοδος Εγγύησης: 1 έτος
2. Είδος Υπηρεσιών Εγγύησης: Υπηρεσία Μονάδων Αντικαθιστώμενων από τον Πελάτη ("CRU") και Υπηρεσίες με Μεταφορά ή Αποστολή από τον Πελάτη
3. Εκδοχή της Δήλωσης Περιορισμένης Εγγύησης: LSOLW-00 05/2005

Για τη λήψη υπηρεσιών εγγύησης, συμβουλευτείτε τον παρακάτω τηλεφωνικό κατάλογο. Για τη λήψη υπηρεσιών εγγύησης σε χώρα που δεν περιλαμβάνεται στον κατάλογο, επισκεφθείτε την ιστοσελίδα [www.lenovo.com/think/support](http://www.lenovo.com/think/support) και επιλέξτε Support Phone List για να πληροφορηθείτε τους τρέχοντες αριθμούς τηλεφώνου. Οι αριθμοί τηλεφώνου υπόκεινται σε αλλαγή χωρίς ειδοποίηση.

## Informatie over de garantie

De volledig Verklaring van beperkte garantie is beschikbaar in 29 talen en kan worden ingezien op de product-CD of online op <http://www.lenovo.com/think/warranty>.

Garantie-informatie voor uw Machine:

1. Garantieperiode: 1 year

2. Type garantieservice: CRU (Customer Replaceable Unit) en Customer Carry-In of Mail-In Service
3. Versie van Verklaring van beperkte garantie: LSOLW-00 05/2005

Voor garantieservice raadpleegt u de telefoonlijst hieronder. Voor niet genoemde landen gaat u naar [www.lenovo.com/think/support](http://www.lenovo.com/think/support) en klikt u op Support Phone List voor een actuele telefoonlijst.

Telefoonnummers kunnen zonder voorafgaand bericht worden gewijzigd.

### Garantioplysninger

Det fulde Servicebevis (Statement of Limited Warranty) er oversat til 29 sprog og findes på produkt-cd'en eller kan læses online på adressen <http://www.lenovo.com/think/warranty>

### Garantioplysninger for Deres Maskine:

1. Garantiperiode: 1 år
2. Servicetype i garantiperioden: CRU-service (Customer Replaceable Unit) og indleveringsservice eller indsendelsesservice
3. Version af Servicebevis: LSOLW-00 05/2005

Se nedenstående telefonliste vedr. garantiservice. Lande, som ikke er nævnt i listen, findes på adressen [www.lenovo.com/think/support](http://www.lenovo.com/think/support). Klik på Support Phone List for at få vist en aktuel liste over telefonnumre. Telefonnumre kan ændres uden forudgående varsel.

### Takuutiedot

Rajoitetun takuun ehdot sisältävä asiakirja on saatavana 29 eri kielellä, ja sitä voi tarkastella tuotteen CD-tietolevyn avulla tai siirtymällä WWW-osoitteeseen <http://www.lenovo.com/think/warranty>.

### Konetta koskevat takuutiedot:

1. Takuuaika: 1 vuosi

2. Takuupalvelun laji: Asiakkaan vaihdettavissa olevia osia (CRU) koskeva palvelu ja asiakkaan toteuttama kuljetus tai postikuljetus
3. Rajoitetun takuun ehtojen versio: LSOLW-00 05/2005

Saat takuupalveluja soittamalla sopivaan alla olevan luettelon puhelinnumeroon. Jos haluamaasi maata ei ole vielä luettelossa, siirry WWW-osoitteeseen [www.lenovo.com/think/support](http://www.lenovo.com/think/support) ja napsauta Support Phone List -linkkiä, jotta näkyviin tulee ajan tasalla oleva maakohtaisten palvelupuhelinnumeroiden luettelo. Puhelinnumerot voivat muuttua ilman ennakoilmoitusta.

### Garantibetingelser

De fullstendige garantibetingelsene er tilgjengelige på 29 språk på produkt-CDen eller på nettadressen <http://www.lenovo.com/think/warranty>

Garantibetingelser som gjelder for din maskin:

1. Garantiperiode: 1 år
2. Type garantiservice: Customer Replaceable Unit ("CRU") og service med innlevering eller innsending
3. Versjon av garantibetingelser: LSOLW-00 05/2005

For garantiservice, se telefonlisten nedenfor. For service i land som ikke er på listen ennå, gå til [www.lenovo.com/think/support](http://www.lenovo.com/think/support) og klikk på Support Phone List for å få en oppdatert telefonliste. Telefonnumre kan endres uten forhåndsvarsel.

## Informacje gwarancyjne

Kompletne Warunki Ograniczonej Gwarancji są dostępne w 29 językach i można się z nimi zapoznać korzystając z dysku CD-ROM produktu lub z adresu

<http://www.lenovo.com/think/warranty>

Informacje gwarancyjne mające zastosowanie do Maszyny Klienta:

1. Okres gwarancyjny: 1 rok
2. Typ serwisu gwarancyjnego: serwis polegający na dostarczeniu Części Wymienianych przez Klienta (Customer Replaceable Unit - CRU) lub serwis z wysyłką lub transportem przez Klienta
3. Warunki Ograniczonej Gwarancji, wersja: LSOLW-00 05/2005

Lista telefonów do osób odpowiedzialnych za serwis gwarancyjny znajduje się poniżej. Aktualne numery telefonów do osób odpowiedzialnych za serwis w krajach nieuwzględnionych poniżej można znaleźć pod adresem [www.lenovo.com/think/support](http://www.lenovo.com/think/support), klikając przycisk Support Phone List. Numery telefonów mogą ulec zmianie bez powiadomienia.

## Informações Sobre a Garantia

A Declaração de Garantia Limitada integral encontra-se disponível em 29 idiomas e pode ser consultada no CD do produto ou em linha no endereço <http://www.lenovo.com/think/warranty>

Informação sobre garantia aplicável à Máquina: 1. Período de Garantia:

1. ano

2. Tipo de Serviço de Garantia: Unidade Substituível pelo Cliente ("CRU") e Serviço de Entrega ou Envio
3. Versão da Declaração de Garantia Limitada: LSOLW-00 05/2005

Para obter o número de telefone de contacto do serviço de garantia, consulte a lista de números telefone abaixo apresentada. Para obter o serviço em países que ainda não constam na lista, consulte o Web site [www.lenovo.com/think/support](http://www.lenovo.com/think/support) e faça clique em Support Phone List para obter uma lista telefónica actual. Os números de telefone estão sujeitos a alteração sem aviso prévio.

### Garantiinformation

Den fullständiga Begränsade garantin (Statement of Limited Warranty) finns på 29 språk och kan läsas i sin helhet på CDn som följer med Maskinen eller på webben, adress <http://www.lenovo.com/think/warranty>

Garantiinformation som gäller den här Maskinen:

1. Garantitid: 1 år
2. Typ av garantiservice: Kunden byter ut delar ("CRU" - Customer Replaceable Unit) och Kunden lämnar in (Customer Carry-In) eller skickar in (Mail-In) Maskinen på service
3. Begränsad garanti, version: LSOLW-00 05/2005

Telefonnummer till ställen där du kan få garantiservice finns i listan nedan. Länder som ännu inte finns i listan kan du hitta på <http://www.lenovo.com/think/support/> Klicka på Support Phone List så får du en aktuell telefonlista. Telefonnummer kan komma att ändras utan att du meddelas om detta.

## Záručné informácie

Kompletné Vyhlásenie o obmedzenej záruke je k dispozícii v 29 jazykoch a môžete si ho pozrieť z produktového CD alebo online na <http://www.lenovo.com/think/warranty>

Záručné informácie týkajúce sa vášho Počítača:

1. Záručná doba: 1 rok
2. Typ záručného servisu: Customer Replaceable Unit ("CRU") a Customer Carry-In alebo Mail-In Service
3. Verzia vyhlásenia o obmedzenej záruke: LSOLW-00 05/2005

Záručný servis konzultujte na čísla v dole uvedenom telefónnom zozname. Servis v krajinách, ktoré tu nie sú uvedené, nájdete na [www.lenovo.com/think/support](http://www.lenovo.com/think/support). Po kliknutí na Support Phone List nájdete aktuálny telefónny zoznam. Telefónne čísla sú predmetom zmeny bez upozornenia.

## Garancijske informacije

Celotna izjava o omejeni garanciji je na voljo v 29 jezikih in se nahaja na priloženem CD-ju ali na spletni strani <http://www.lenovo.com/think/warranty>

Garancijski pogoji, ki veljajo za vaš računalnik:

1. Garancijsko obdobje: 1 leto
2. Vrsta garancijskega servisa: del, ki ga lahko zamenja stranka ("CRU") in servis s strankino ali poštno dostavo
3. Različica izjave o omejeni garanciji: LSOLW-00 05/2005

Za garancijski servis si oglejte spodnji seznam telefonskih števil. Za servis v državah, ki jih seznam še ne vključuje, obiščite [www.lenovo.com/think/support](http://www.lenovo.com/think/support) in za najnovejši seznam telefonskih števil kliknite Support Phone List (Seznam telefonskih števil za podporo). Pridržujemo si pravico do sprememb telefonskih števil brez predhodnega obvestila.

## Гаранционна информация

Пълният текст на Ограничените гаранционни условия е достъпен на 29 езика, и може да бъде прегледан от продуктивния CD или онлайн на <http://www.lenovo.com/think/warranty>

Гаранционна информация, приложима за вашата Машина:

1. Гаранционен период: 1 година
2. Тип гаранционно обслужване: Подменяеми от клиента части ("CRU") и обслужване с доставяне от клиента или по пощата
3. Версия на Ограничените гаранционни условия: LSOLW-00 05/2005

За гаранционно обслужване вижте списъка с телефони по-долу. За обслужване в споменати засега страни, посетете [www.lenovo.com/think/support](http://www.lenovo.com/think/support), и щракнете на Support Phone List за актуален списък на телефоните. Телефонните номера подлежат на промяна без предизвестие.



## Jótállási tájékoztatás

A Korlátozott jótállási nyilatkozat 29 nyelven rendelkezésre áll, és megtekinthető a termék CD-n vagy a <http://www.lenovo.com/think/warranty> címen.

A gépre vonatkozó jótállási feltételek:

1. Jótállási időtartam: 1 év
2. Garanciális szerviz típusa: Felhasználó által cserélhető egység ("CRU") és beszállításos vagy postázásos szerviz
3. Korlátozott jótállási nyilatkozat száma: LSOLW-00 05/2005

A garanciális szervizről az alábbi telefonszámokon érdeklődhet. A fel nem sorolt országokban rendelkezésre álló szervizekről a [www.lenovo.com/think/support](http://www.lenovo.com/think/support) címen tájékozódhat (kattintson a Support Phone List elemre az aktuális telefonszámokért).

A telefonszámok bejelentés nélkül megváltozhatnak.

## Garanti Bilgileri

Sınırlı Garanti Bildirimi'nin tamamı 29 dile çevrilmiştir ve ürün CD'sinden ya da çevrimiçi olarak aşağıdaki adresten görüntülenebilir: <http://www.lenovo.com/think/warranty>

Makineniz için geçerli Garanti Bilgileri:

1. Garanti Süresi: 1 yıl
2. Garanti Hizmetinin Tipi: Müşteri Tarafından Değiştirilebilir Birim ("CRU") ve Müşteri Tarafından Teslim ve Postayla Teslim Hizmeti
3. Sınırlı Garanti Bildirimi'nin Sürümü: LSOLW-00 05/2005

Garanti hizmeti için aşağıdaki telefon listesine bakın. Listede olmayan ülkelerdeki hizmetler için [www.lenovo.com/think/support](http://www.lenovo.com/think/support) adresine gidip Support Phone List seçeneğini tıklayarak güncel telefon listesine ulaşabilirsiniz. Telefon numaraları bildirilmeden değiştirilebilir.

## Informacije o jamstvu

Potpuna Izjava o ograničenom jamstvu je dostupna na 29 jezika i može se vidjeti na CD-u s proizvodom ili online na <http://www.lenovo.com/think/warranty>

Informacije o jamstvu koje se odnose na vaš Stroj:

1. Period jamstva: 1 godina
2. Tip jamstvenog servisa: Korisnički zamjenjiva jedinica ("CRU") i Servis s Korisničkom ili Poštanskom dostavom
3. Izjava o ograničenom jamstvu Verzija: LSOLW-00 05/2005

Radi jamstvenog servisa pogledajte donji popis telefona. Za servis u zemljama koje još nisu na popisu posjetite <http://www.lenovo.com/think/support/> i kliknite Popis telefona za podršku za trenutni popis telefona. Telefonski brojevi se mogu promijeniti bez prethodne obavijesti.

## Informace o záruce

Úplné Prohlášení o omezené záruce je k dispozici v 29 jazycích a můžete si jej prohlédnout na disku CD nebo na webové stránce <http://www.lenovo.com/think/warranty>

Informace o záruce vztahující se k vašemu stroji:

1. Záruční doba: 1rok.
2. Typ záručního servisu: CRU (Customer Replaceable Unit, díly vyměnitelné zákazníkem) a servis typu Customer Carry-In nebo Mail-In.
3. Prohlášení o omezené záruce, verze: LSOLW-00 05/2005

Informace o záručním servisu získáte na následujících telefonních číslech. Není-li na seznamu uvedeno číslo země, kterou hledáte, navštivte webové stránky [www.lenovo.com/think/support](http://www.lenovo.com/think/support), klepněte na odkaz Support Phone List (telefonní seznam podpory) a zobrazí se aktuální telefonní seznam. Telefonní čísla se mohou měnit bez předchozího upozornění.

## מידע אחריות

הצהרת האחריות המוגבלת המלאה זמינה ב-29 שפות, וניתן למצוא אותה בתקליטור המוצר, או באופן מקוון, בכתובת

<http://www.lenovo.com/think/warranty>

מידע אחריות הישים למחשב שלכם:

1. תקופת אחריות: שנה אחת
2. סוג של שירות אחריות: יחידות להחלפה עצמית ("CRU") ושירות נשיאה עצמית של לקוחות או משלוח בדואר
3. גרסת הצהרת האחריות המוגבלת: 05/2005 LSOLW-00

לקבלת שירות אחריות, עיינו ברשימת הטלפונים שלהלן. לקבלת שירות במדינות שאינן מפורטות, בקרו באתר [www.lenovo.com/think/support](http://www.lenovo.com/think/support), ולחצו על Support Phone List לקבלת רשימת טלפונים עדכנית. מספרי הטלפון ניתנים לשינוי ללא הודעה מראש.

## Информация о гарантии

Полный текст Заявления об ограниченной гарантии переведен на 29 языков; с ним можно ознакомиться на компакт-диске продукта или на Web-сайте <http://www.lenovo.com/think/warranty>

Информация о гарантии для вашего компьютера:

1. Гарантийный срок: 1 год
2. Тип гарантийного обслуживания: Обслуживание при отказе узлов, подлежащих замене силами заказчика (CRU), и обслуживание при доставке или пересылке по почте силами заказчика.
3. Версия Заявления об ограниченной гарантии: LSOLW-00 05/2005

За гарантийным обслуживанием обращайтесь по телефонам, приведенным ниже. Если в списке нет телефона для вашей страны, посетите сайт <http://www.lenovo.com/think/support/> и щелкните по Support Phone List (Список телефонов поддержки), чтобы просмотреть текущий список телефонов. Приведенные здесь номера телефонов могут измениться без дополнительного уведомления.

## معلومات الضمان

البيان الكامل للضمان المحدود متاح في ٢٩ لغة ويمكن مشاهدته من خلال القرص المدمج للمنتج أو على الانترنت بالموقع  
<http://www.lenovo.com/think/warranty>

معلومات الضمان التي سيتم تطبيقها على الجهاز الخاص بك:

1. فترة الضمان: سنة
2. نوع خدمة الضمان: Customer Carry-In و Customer Replaceable Unit ("CRU") أو Mail-In Service
3. بيان نسخة الضمان المحدود: LSOLW-00 05/2005

بالنسبة لخدمة الضمان، ارجع الى كشف التليفونات الموجود بأسفل. بالنسبة للبلاد التي لا يتم عرضها، ارجع الى الموقع / [www.lenovo.com/think/support](http://www.lenovo.com/think/support) واضغط على دعم كشف التليفونات لعرض كشف التليفونات الحالي. ارقام التليفون عرضة للتغيير بدون أي إشعار.

## بمعلومات

يمكن 29 لغة الحصول على "بيان الضمان"، ويمكن الحصول على المنتج CD من الموقع <http://www.lenovo.com/think/warranty> في الموقع  
الضمان "بيان الضمان"

معلومات الضمان الخاصة بجهازك:

1. مدة الضمان: ١ سنة
2. نوع خدمة الضمان: يمكن للعميل تغيير الأجزاء ("CRU") وإرسال الجهاز  
أو إرساله
3. "بيان الضمان" الإصدار: LSOLW-00 05/2005

الأسفل هي قائمة بأرقام الهاتف الاستشاري للخدمة. في البلدان التي لم يتم إدراجها، يرجى زيارة [www.lenovo.com/think/support](http://www.lenovo.com/think/support) والنقر على Support Phone List للحصول على قائمة الأرقام الهاتفية الحالية. الأرقام الهاتفية قابلة للتغيير دون إشعار.

## 保固資訊

完整的有限保固聲明共有 29 個語言版本，您可從產品光碟或 <http://www.lenovo.com/think/warranty> 網站查閱。

您機器的保固資訊如下：

1. 保固期限：1 年
2. 保固服務類型：客戶可自行更換組件 ("CRU") 及客戶親自或郵寄送修服務
3. 有限保證聲明版本：LSOLW-00 05/2005

保固維修服務電話清單如下。若找不到某些國家的服務電話，請造訪 [www.lenovo.com/think/support](http://www.lenovo.com/think/support)，然後按一下 Support Phone List 以查閱目前的電話清單。電話號碼若有變更恕不另行通知。



## 보증 정보

완료된 보증 제한 설명서는 29개 언어로 사용 가능하며, 제품 CD나 <http://www.lenovo.com/think/warranty>에서 온라인으로 볼 수 있습니다.

사용자 시스템에 적용되는 보증 정보:

1. 보증 기간: 1년
2. 보증 서비스 유형: 고객 교체 가능 유닛(CRU) 및 고객 직접 운송 또는 우편 서비스
3. 보증 제한 설명서 버전: LSOLW-00 05/2005

보증 서비스에 대해서는 아래 나열된 전화번호로 문의하십시오. 아직 목록에 반영되지 않은 국가에서의 서비스를 위해 [www.lenovo.com/think/support](http://www.lenovo.com/think/support)를 방문하여 Support Phone List를 누르면 최신 전화번호 목록을 알 수 있습니다. 전화번호는 사전 통고없이 변경될 수 있습니다.

## 保証情報

完全な「保証の内容と制限」は 29 か国語で提供され、プロダクト CD または Web サイトの <http://www.lenovo.com/think/warranty> でご覧になれます。

ご使用のマシンの保証情報は次のとおりです:

1. 保証期間: 1 年
2. 保証サービスの種類: お客様での取り替え可能部品 (CRU) および持ち込みまたは郵送サービス
3. 保証の内容と制限のバージョン: LSOLW-00 05/2005

保証サービスについては、以下リストにある電話番号にお問い合わせください。リストにない国におけるサービスについては、Web サイト <http://www.lenovo.com/think/support> にアクセスして、「Support Phone List」をクリックして最新の電話番号リストをご覧ください。電話番号は、予告なしに変更される場合があります。

---

## Worldwide telephone list

Phone numbers are subject to change without notice. For the most current phone numbers, go to <http://www.lenovo.com/think/support> and click **Support phone list**.

Country or Region	Telephone Number
Africa	Africa: +44 (0)1475 555 055 South Africa: +27 11 3028888 and 0800110756 Central Africa: Contact the nearest IBM Business Partner
Argentina	0800-666-0011 (Spanish)

<b>Country or Region</b>	<b>Telephone Number</b>
Australia	131-426 (English)
Austria	+43-1-24592-5901 (German)
Belgium	02-210-9820 (Dutch) 02-210-9800 (French)
Bolivia	0800-0189 (Spanish)
Brazil	Sao Paulo region: (11) 3889-8986 Toll free outside Sao Paulo region: 0800-7014-815 (Brazilian Portuguese)
Canada	1-800-565-3344 (English, French) In Toronto only call: 416-383-3344
Chile	800-224-488 (Spanish)
China	800 810 1818 (Mandarin)
China (Hong Kong S.A.R.)	Home PC: 852 2825 7799 Commercial PC: 852 8205 0333 ThinkPad and WorkPad: 852 2825 6580 (Cantonese, English, Putonghua)
Colombia	1-800-912-3021 (Spanish)
Costa Rica	284-3911 (Spanish)
Cyprus	+357-22-841100
Czech Republic	+420-2-7213-1316
Denmark	4520-8200 (Danish)
Dominican Republic	566-4755 566-5161 ext. 8201 Toll Free within the Dominican Republic: 1-200-1929 (Spanish)
Ecuador	1-800-426911 (Spanish)
El Salvador	250-5696 (Spanish)

<b>Country or Region</b>	<b>Telephone Number</b>
Estonia	+386-61-1796-699
Finland	+358-9-459-6960 (Finnish)
France	+33-238-557-450 (French)
Germany	+49-7032-15-49201 (German)
Greece	+30-210-680-1700
Guatemala	335-8490 (Spanish)
Honduras	Tegucigalpa & San Pedro Sula: 232-4222 San Pedro Sula: 552-2234 (Spanish)
Hungary	+36-1-382-5720
India	1600-44-6666 (English)
Indonesia	800-140-3555 (Bahasa, Indonesian, English)
Ireland	+353-(0)1-815-9200 (English)
Italy	+39-02-7031-6101 (Italian)

Country or Region	Telephone Number
Japan	<p>Desktop: Toll free: 0120-887-870 For International: +81-46-266-4724</p> <p>ThinkPad: Toll free: 0120-887-874 For International: +81-46-266-4724</p> <p>Both of the above numbers will be answered with a Japanese language voice prompt. For telephone support in English, please wait for the Japanese voice prompt to end, and an operator will answer. Please ask for "English support please," and your call will be transferred to an English speaking operator.</p> <p>PC Software: 0120-558-695 Overseas calls: +81-44-200-8666 (Japanese)</p>
Korea	1588-5801 (Korean)
Latvia	+386-61-1796-699
Lithuania	+386-61-1796-699
Luxembourg	+352-298-977-5063 (French)
Malaysia	1800-88-8558 (English)
Malta	+356-23-4175
Mexico	001-866-434-2080 (Spanish)
Middle East	+44 (0)1475-555-055
Netherlands	+31-20-514-5770 (Dutch)
New Zealand	0800-446-149 (English)
Nicaragua	255-6658 (Spanish)

<b>Country or Region</b>	<b>Telephone Number</b>
Norway	NetVista, ThinkCentre, and ThinkPad: +47 6699 8960 All products: +47 815 21550 (Norwegian)
Panama	206-6047 (Spanish)
Peru	0-800-50-866 (Spanish)
Philippines	1800-1888-1426 (English)
Poland	+48-22-878-6999
Portugal	+351-21-892-7147 (Portuguese)
Russian Federation	+7-095-940-2000 (Russian)
Singapore	1800-3172-888 (English)
Slovakia	+421-2-4954-1217
Slovenia	+386-1-5830-050
Spain	+34-91-714-7983 (Spanish)
Sri Lanka	+94-11-2448-442 +94-11-2421-066 +94-11-2493-500 (English)
Sweden	+46-8-477-4420 (Swedish)
Switzerland	+41-58-333-0971 (German, French, Italian)
Taiwan	886-2-8723-9799 (Mandarin)
Thailand	1-800-299-229 (Thai)
Turkey	00800-211-4032 +90-212-317-1760 (Turkish)
United Kingdom	+44-1475-555-055 (English)

<b>Country or Region</b>	<b>Telephone Number</b>
United States	(1-800-426-7378) (English)
Uruguay	000-411-005-6649 (Spanish)
Venezuela	0-800-100-2011 (Spanish)
Vietnam	Ho Chi Minh: (848) 824-1474 Hanoi: (844) 842-6316 (English, Vietnamese)

---

## **Guarantee supplement for Mexico**

This supplement is considered part of Lenovo's Statement of Limited Warranty and shall be effective solely and exclusively for products distributed and commercialized within Territory of the Mexican United States. In the event of a conflict, the terms of this supplement shall apply.

All software programs pre-loaded in the equipment shall only have a thirty- (30) day guarantee for installation defects from the date of purchase. Lenovo is not responsible for the information in such software programs and/or any additional software programs installed by you or installed after purchase of the product.

Services not chargeable to the guarantee shall be charged to the final user, prior an authorization.

In the event that warranty repair is required please call the Customer Support Center at 001-866-434-2080, where you will be directed to the nearest Authorized Service Center. Should no Authorized Service Center exist in your city, location or within 70 kilometers of your city or location, the guarantee includes any reasonable delivery charges related to the transportation of the product to our nearest Authorized Service Center. Please call the nearest Authorized Service Center to obtain the necessary approvals or information concerning the shipment of the product and the shipment address.

To obtain a list of Authorized Service Centers, please visit:  
<http://www.lenovo.com/think/support/site.wss/document.do?lnocid=MIGR-44986&sitestyle=lenovo>

**Manufactured by:**

**SCI Systems de México, S.A. de C.V.**  
**Av. De la Solidaridad Iberoamericana No. 7020**  
**Col. Club de Golf Atlas**  
**El Salto, Jalisco, México**  
**C.P. 45680,**  
**Tel. 01-800-3676900**

**Marketing by:**

**Lenovo de México, Comercialización y**  
**Servicios, S. A. de C. V.**  
**Alfonso Nápoles Gándara No 3111**  
**Parque Corporativo de Peña Blanca**  
**Delegación Álvaro Obregón**  
**México, D.F., México**  
**C.P. 01210,**  
**Tel. 01-800-00-325-00**



---

## Appendix C. Notices

Lenovo may not offer the products, services, or features discussed in this document in all countries. Consult your local Lenovo representative for information on the products and services currently available in your area. Any reference to a Lenovo product, program, or service is not intended to state or imply that only that Lenovo product, program, or service may be used. Any functionally equivalent product, program, or service that does not infringe any Lenovo intellectual property right may be used instead. However, it is the user's responsibility to evaluate and verify the operation of any other product, program, or service.

Lenovo may have patents or pending patent applications covering subject matter described in this document. The furnishing of this document does not give you any license to these patents. You can send license inquiries, in writing, to:

*Lenovo (United States), Inc.  
500 Park Offices Drive, Hwy. 54  
Research Triangle Park, NC 27709  
U.S.A.  
Attention: Lenovo Director of Licensing*

LENOVO GROUP LTD. PROVIDES THIS PUBLICATION "AS IS" WITHOUT WARRANTY OF ANY KIND, EITHER EXPRESS OR IMPLIED, INCLUDING, BUT NOT LIMITED TO, THE IMPLIED WARRANTIES OF NON-INFRINGEMENT, MERCHANTABILITY OR FITNESS FOR A PARTICULAR PURPOSE. Some jurisdictions do not allow disclaimer of express or implied warranties in certain transactions, therefore, this statement may not apply to you.

This information could include technical inaccuracies or typographical errors. Changes are periodically made to the information herein; these changes will be incorporated in new editions of the publication. Lenovo

may make improvements and/or changes in the product(s) and/or the program(s) described in this publication at any time without notice.

The products described in this document are not intended for use in implantation or other life support applications where malfunction may result in injury or death to persons. The information contained in this document does not affect or change Lenovo product specifications or warranties. Nothing in this document shall operate as an express or implied license or indemnity under the intellectual property rights of Lenovo or third parties. All information contained in this document was obtained in specific environments and is presented as an illustration. The result obtained in other operating environments may vary.

Lenovo may use or distribute any of the information you supply in any way it believes appropriate without incurring any obligation to you.

Any references in this publication to non-Lenovo Web sites are provided for convenience only and do not in any manner serve as an endorsement of those Web sites. The materials at those Web sites are not part of the materials for this Lenovo product, and use of those Web sites is at your own risk.

Any performance data contained herein was determined in a controlled environment. Therefore, the result obtained in other operating environments may vary significantly. Some measurements may have been made on development-level systems and there is no guarantee that these measurements will be the same on generally available systems. Furthermore, some measurements may have been estimated through extrapolation. Actual results may vary. Users of this document should verify the applicable data for their specific environment.

---

## Trademarks

The following terms are trademarks of Lenovo in the United States, other countries, or both:

Lenovo

ThinkCentre

ThinkPad

IBM is a trademark of International Business Machines Corporation in the United States, other countries, or both.

Other company, product, or service names may be trademarks or service marks of others.

© Copyright Lenovo 2005.

### **All rights reserved.**

U.S. GOVERNMENT USERS – RESTRICTED RIGHTS: Our products and/or services are provided with RESTRICTED RIGHTS. Use, duplication or disclosure by the Government is subject to the GSA ADP Schedule contract with Lenovo Group Limited, if any, or the standard terms of this commercial license, or if the agency is unable to accept this Program under these terms, then we provide this Program under the provisions set forth in Commercial Computer Software–Restricted Rights at FAR 52.227-19, when applicable, or under Rights in Data-General, FAR 52.227.14 (Alternate III).





# ThinkPad®

Part Number: 73P5189

Printed in USA

(1P) P/N: 73P5189

